

MSU Main Library Floor Plan Guide

- 4-EAST**
- Call #s Main L—P
 - Faculty Carrels (E409—E420)

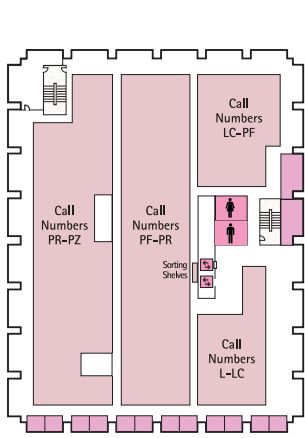

- 3-EAST**
- Call #s Main F—J
 - Faculty Carrels (E309—E320)

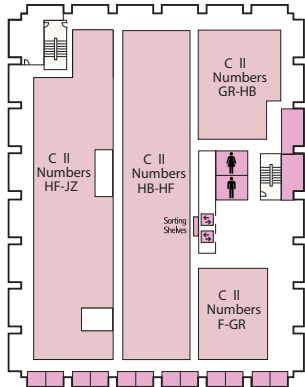

- 2-EAST**
- Call #s Main A—E
 - Africana Reference Coll.
 - Area Studies Collection
 - Faculty Carrels (E209—E220)
 - Graduate Carrels (E208)
 - Graduate Lockers

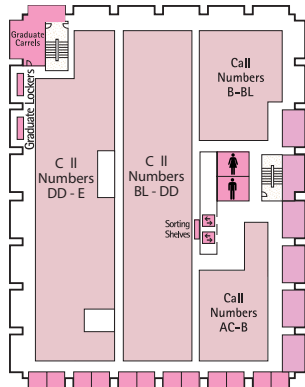

- 1-EAST**
- Beaumont Instruction Rm.
 - Browsing Coll.
 - Careers/Travel/College Guides
 - Circulation Desk
 - Funding Center
 - Government Documents Reference Coll.
 - Reference Coll.
 - Reference Instruction Rm.
 - Statistics Alcove

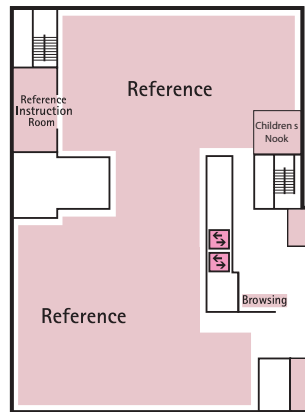

- 1-CENTER**
- Assistive Technology Center
 - Checkout Desk
 - Reference Desk

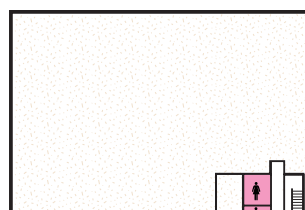

- BASEMENT-EAST**
- Call #s Main T—Z
 - Basement Instruction Room

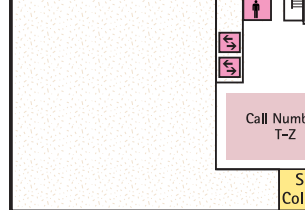

- BASEMENT-CENTER**
- Call #s Main RG138—T
 - Graduate Carrels (Rm. WG17)
 - Graduate Lockers
 - Special Collections Reading Room



CENTER

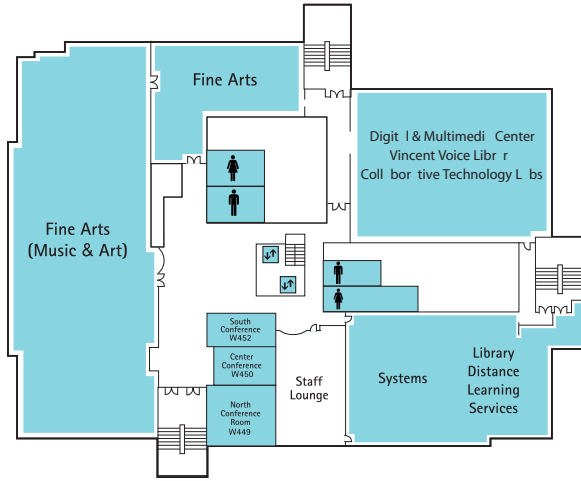

- 4-WEST**
- Collaborative Technology Labs
 - Digital and Multimedia Center including the Vincent Voice Library
 - Fine Arts Library (Music & Art): Call #s Main M, ML, MT, N and TR
 - North Conference Room (W449)

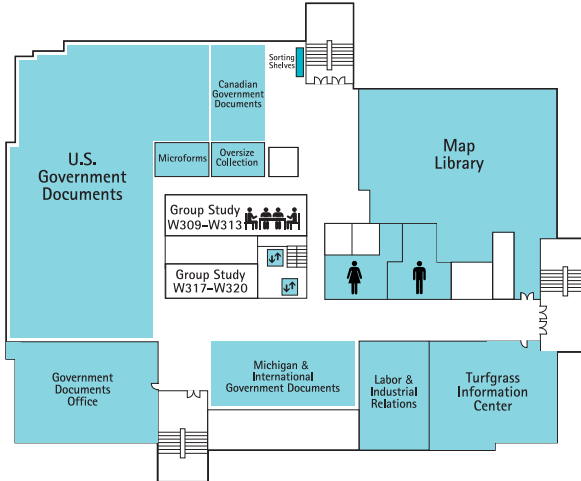

- 3-WEST**
- Labor & Industrial Relations Library
 - Michigan & Canadian Gov. Docs.
 - Map Library: Call #s Main G1000—9999
 - Turfgrass Info. Center
 - U.S. Government Documents

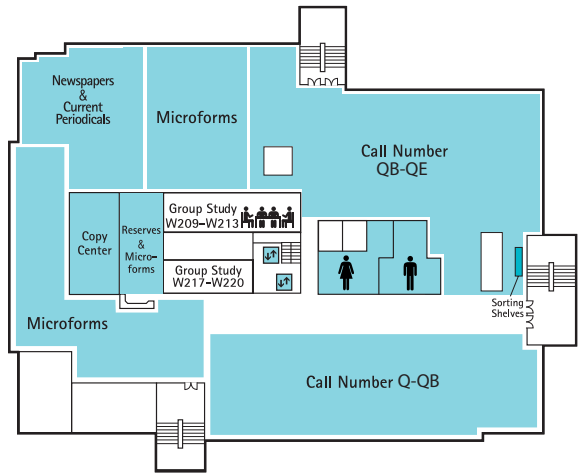

- 2-WEST**
- Call #s Main Q—QE
 - Copy Center
 - Microforms Collection
 - Newspapers & Current Periodicals
 - Reserve Reading & Microforms Service Desk

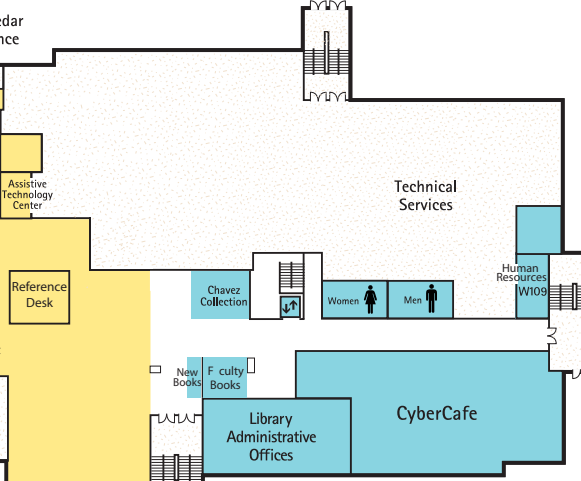

- 1-WEST**
- Chavez Collection
 - Cyber Café
 - Faculty Book Collection
 - Library Administrative Offices
 - Library Human Resources Office

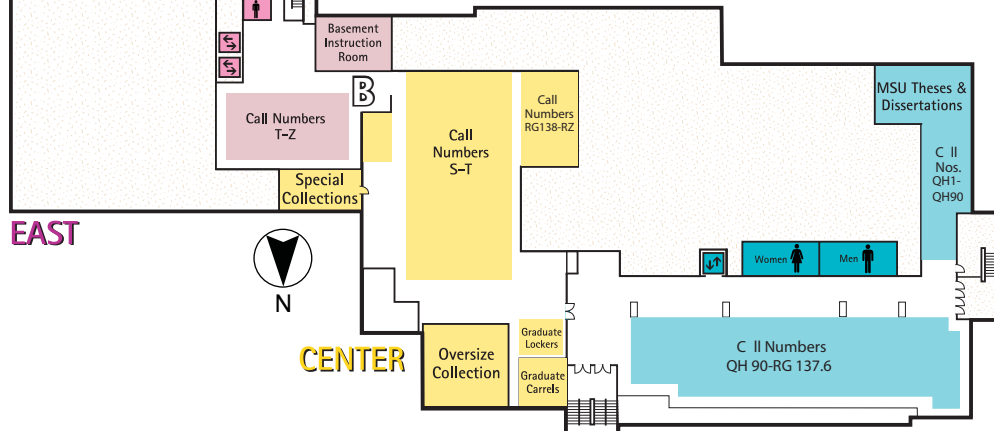

- BASEMENT-WEST**
- Call #s Main QH1—RG137.6
 - MSU Theses & Dissertations

WEST

Collectively, the MSU Libraries house almost 5 million volumes and more than 38,000 magazine and journal subscriptions (in print and electronic form). The Main Library building is divided into an east wing and west wing; these two wings are connected ONLY on the first floor and the basement. Additionally, the MSU Libraries catalog includes materials from the Library of Michigan and the MSU Law Library.

MSU Main Library CALL NUMBER LOCATIONS

Generally, call numbers in the location "MAIN" are as follows:

| Call numbers beginning with: | Located on this floor: |
|------------------------------|------------------------|
| A–E..... | 2 East |
| F–J..... | 3 East |
| L and P | 4 East |
| Q–QE..... | 2 West |
| QH1–QH90.A1 G513..... | Basement West(WG-7) |
| QH90.A1 N4–QR..... | Basement West |
| R–RG137.6..... | Basement West |
| RG138–RZ | Basement Center |
| S | Basement Center |
| T–TP845.C6 | Basement Center |
| TP845.G3–TX..... | Basement East |
| U–Z..... | Basement East |

Exceptions are:

| | |
|---------------------------------|----------------------|
| K..... | 50 Law College Bldg. |
| M, ML, MT, N and TR | 4 West (Fine Arts) |
| G1000–9999..... | 3 West (Maps) |
| A–Z Oversized Volumes | Basement Center |
| MSU Theses & Dissertations | Basement West(WG-7) |
| Indexes & Abstracts..... | 1 East |

Other Main Library Locations:

(Displayed in the "Location" field of catalog Records)

| | |
|--|---------------|
| Africana | 2 East |
| Biography Tools/College Guides/ Funding Center/ Career Collection/Travel Guides | 1 East |
| Consulting Reference | 1 East |
| Current Periodicals/Microforms/ Reserves | 2 West |
| Digital & Multimedia Center/ Vincent Voice Library/Software | 4 West |
| Fine Arts (Art, Music)..... | 4 West |
| Government Documents..... | 3 West |
| Government Documents Reference... .. | 1 East |
| Labor and Industrial Relations..... | 3 West |
| Law Tools/Reporters..... | 1 East |
| Maps..... | 3 West |
| Reference | 1 East |
| Special Collections Reading Room | Basement East |
| Statistics Alcove..... | 1 East |
| Turfgrass Information Center..... | 3 West |

MSU Libraries' ON-CAMPUS LOCATIONS:

- **Biomedical & Physical Sciences Library**
1440 Biomedical and Physical Sciences Building,
432-4900 x1990
- **Business Library** – 50 MSU Law College Building,
355-3380
- **Cyclotron Library** – 133 Cyclotron Building, 353-5959
- **Engineering Library** – 1515 Engineering Building,
355-8536
- **Instructional Media Center** – 126 Instructional Media
Center, 353-3960
- **International Center Library** – 115 International
Center, 355-0253
- **James Madison Library** – South Case Hall
- **Law Library** – MSU Law College Building, 432-6860
- **Math Library** – 101D Wells Hall, 353-8852
- **Planning & Design Library** – 210 Urban Planning &
Landscape Architecture, 353-3941
- **Veterinary Medical Library** – G201 Veterinary
Medical Center, 353-5099
- **Michigan State University Archives & Historical
Collections** – 101 Conrad Hall, 355-2330

MSU Libraries' OFF-CAMPUS LOCATIONS:

- **Gull Lake Library** – W. K. Kellogg Biological Station,
3700 East Gull Lake Drive, Hickory Corners, MI
49060; 199-2310 (from campus), or 269/671-2310

NON-MSU LOCATIONS:

Records in the catalog may display location codes beginning with LIB of MICH (Library of Michigan).

Library of Michigan (LIB of MICH)

- **Michigan Library and Historical Center**
702 West Kalamazoo Street, Lansing, MI 48989
Reference: 517/373-1300
URL: <http://www.michigan.gov/libraryofmichigan>
- **Library of Michigan Law Library**
Mennen Williams State Office Building, 525 West
Ottawa Street, Lansing, MI 48933
Reference: 517/373-0630
- **State of Michigan Archives**
Michigan Library and Historical Center
702 West Kalamazoo Street, Lansing, MI 48989
Reference: 517/373-1408

Having trouble finding what you are looking for?
Go to the Reference desk on the 1st floor, or pick up a red help phone.